

4 PIPE INSTALLATION

Pipe installation, general

Enter a short description of your concept here (optional).
This is the start of your concept.

Pipe connections

Measurements and dimensions

Enter a short description of your concept here (optional).
This is the start of your concept.

Preparations

If the pipes are mounted laterally, use sheet metal scissors or similar to cut the gas separator casing along the perforated line.

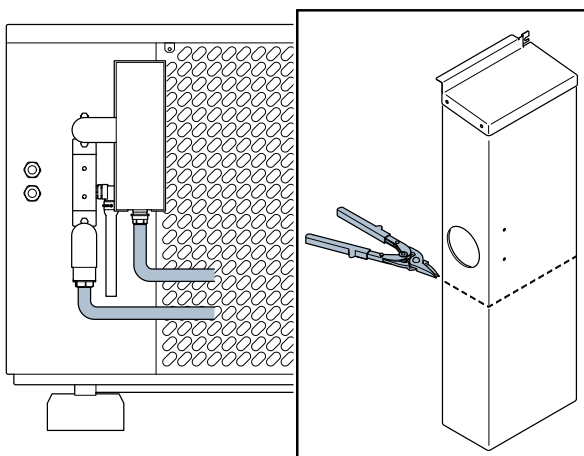

If the pipes are mounted vertically, the gas separator casing does not need to be modified.

Installation

Enter a short description of your task here (optional).

1. Install the supplied 90-degree couplings in the pipe connections at the back of the unit.



NOTE

Do not remove the pre-fitted screws that are mounted above and below the pipe connections.

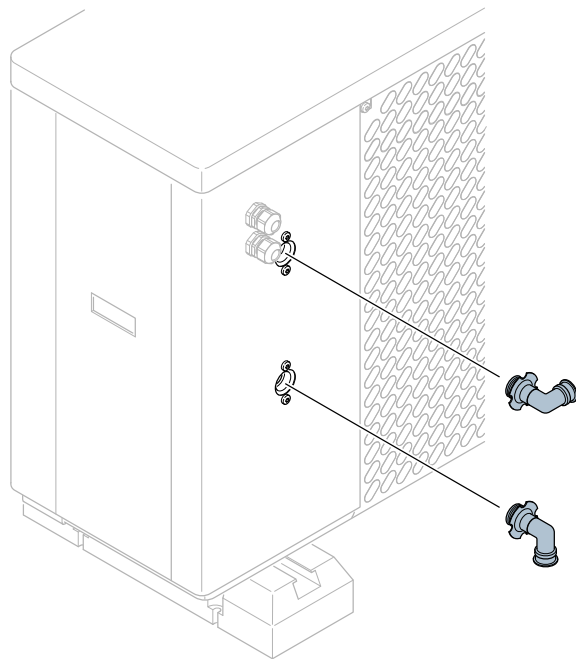

2. Ensure that the 90-degree coupling are mounted so that the coupling for the heating medium supply (XL7) points to the right and that the coupling for the heating medium return (XL8) points downwards.

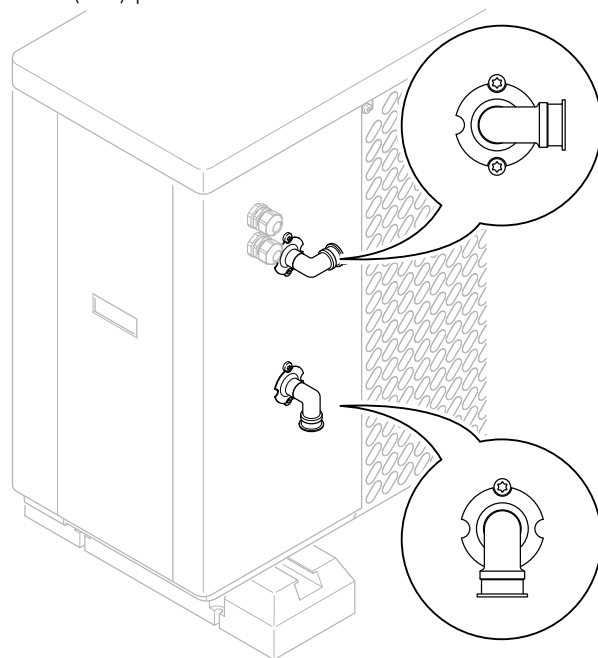

3. Remove the pre-fitted screws from the unit.

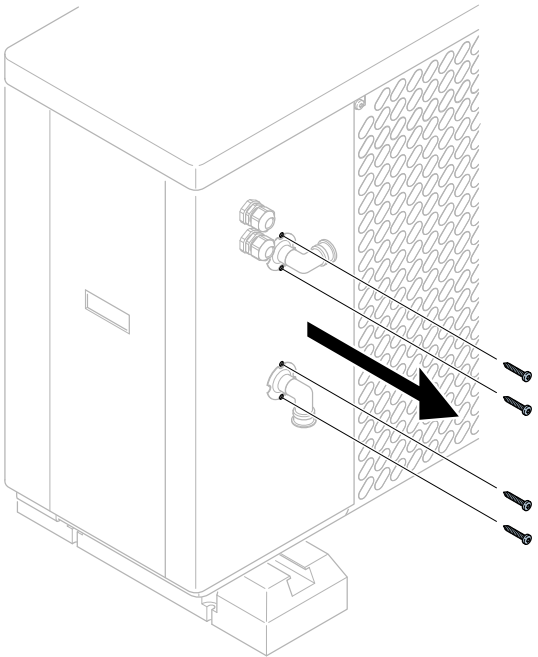

4. Fasten the 90-degree couplings and the supplied bracket with the supplied hexagonal screws.

! CAUTION
Fasten the top and bottom screws before fastening the bracket.

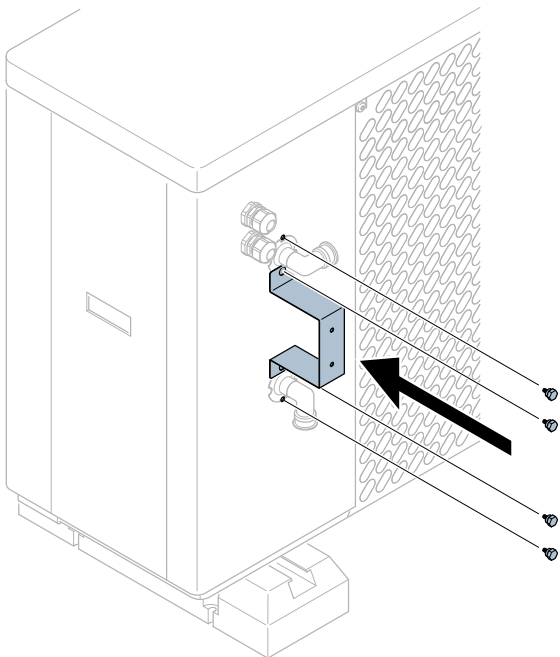

5. Install the gas separator (HN1) on the upper 90-degree coupling and the check valve (XX#) on the lower 90-degree coupling.

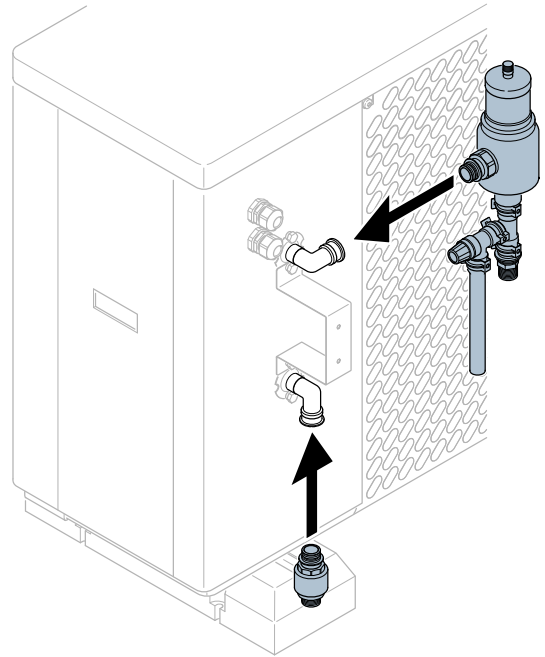

6. Mount the supplied click-fittings at the pipe transitions.

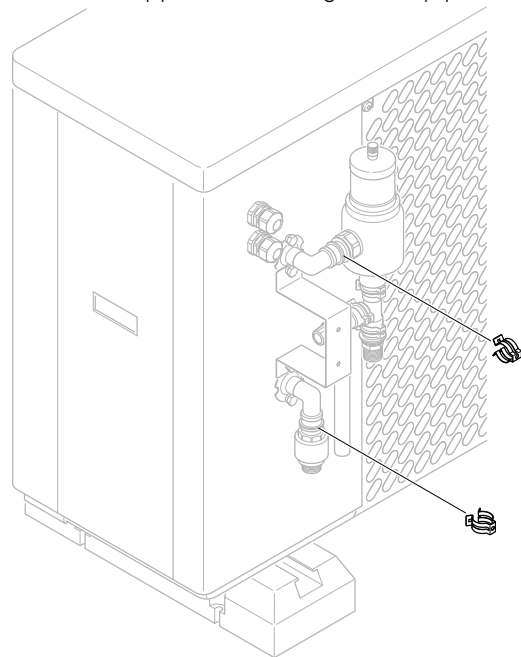

7. Attach condensation insulation along the pipes, from the back of the heat pump to the gas separator and over the check valve.

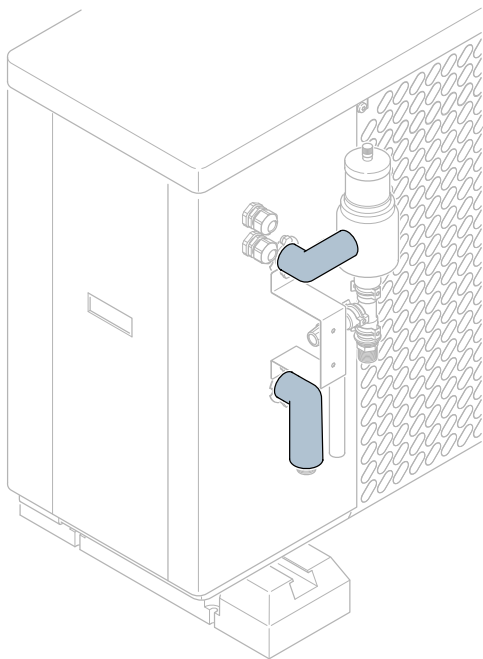

8. Install the rear and front insulation blocks around the gas separator.

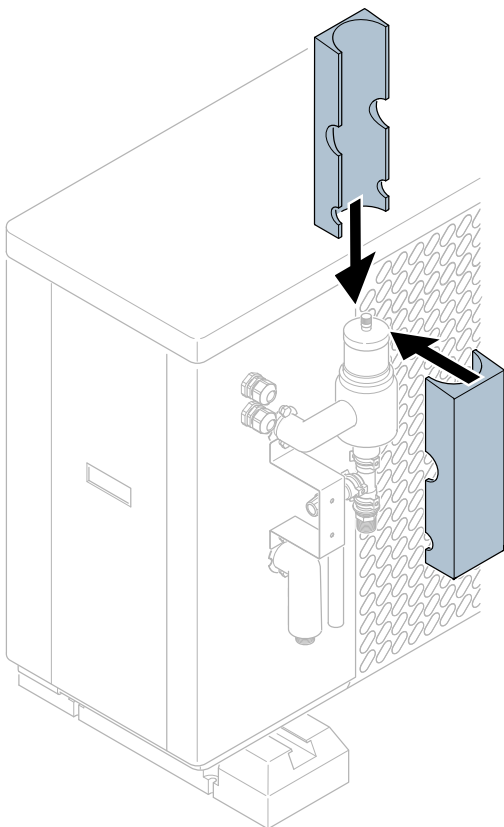

9. Install the pipes for the distribution system to the unit.
 - a) Connect the heating medium supply line to the gas separator outlet (XL##).
 - b) Connect the heating medium return line to the check valve (XX#).

INSERT IMAGE

10. Mount the circular insulation lids at the top and bottom of the insulation blocks.



NOTE

Mount the angled insulation lid at the top, and the open-end insulation lid at the bottom.

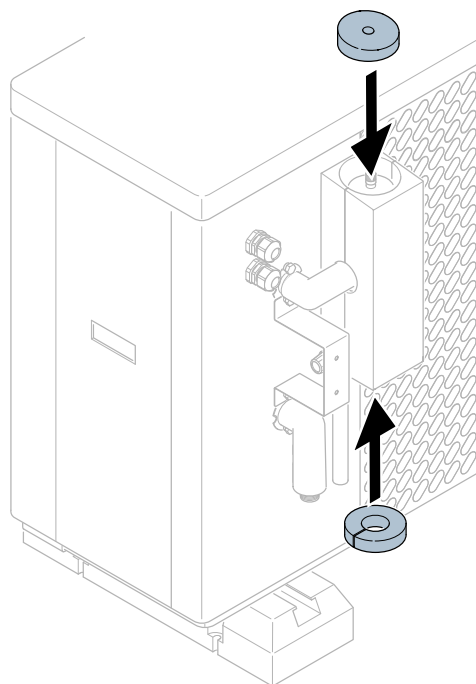

11. Install self-adhesive condensation insulation around gaps and pipe penetrations.

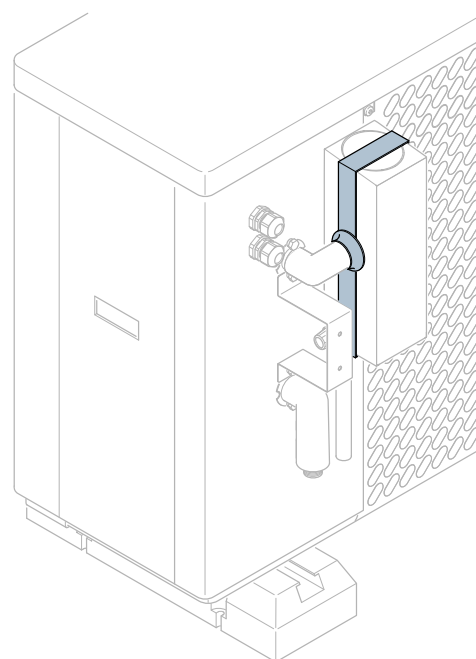

12. Remove the top cover from the unit.
 - a) Remove the two screws from the back of the unit.

b) Tilt the rear of the cover upwards.



NOTE

The cover is held in place by clips at the front of the unit. Ensure that the top is detached from the clips.

c) Remove the top cover from the unit.

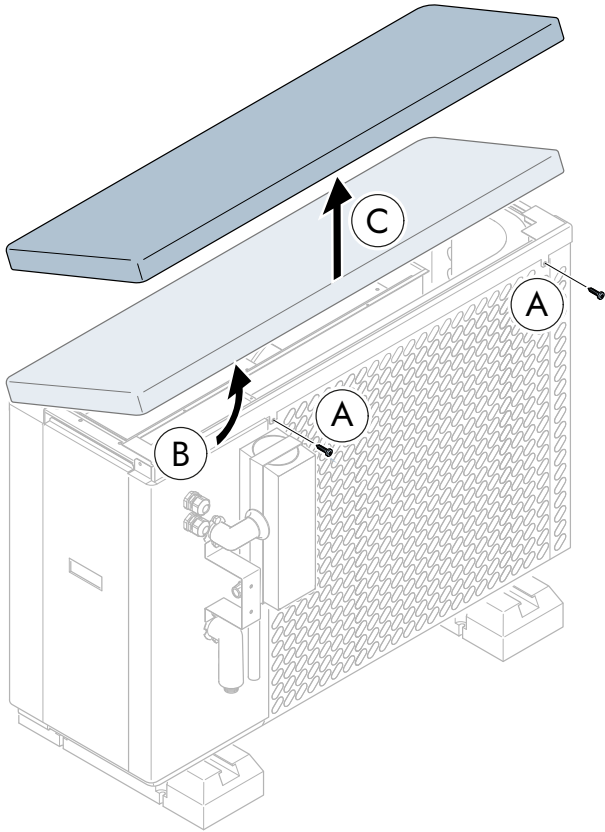

13. Install the gas separator casing on the bracket by using the supplied screws and washers.



NOTE

The tab at the top of the gas separator casing must rest on the ledge of the unit.

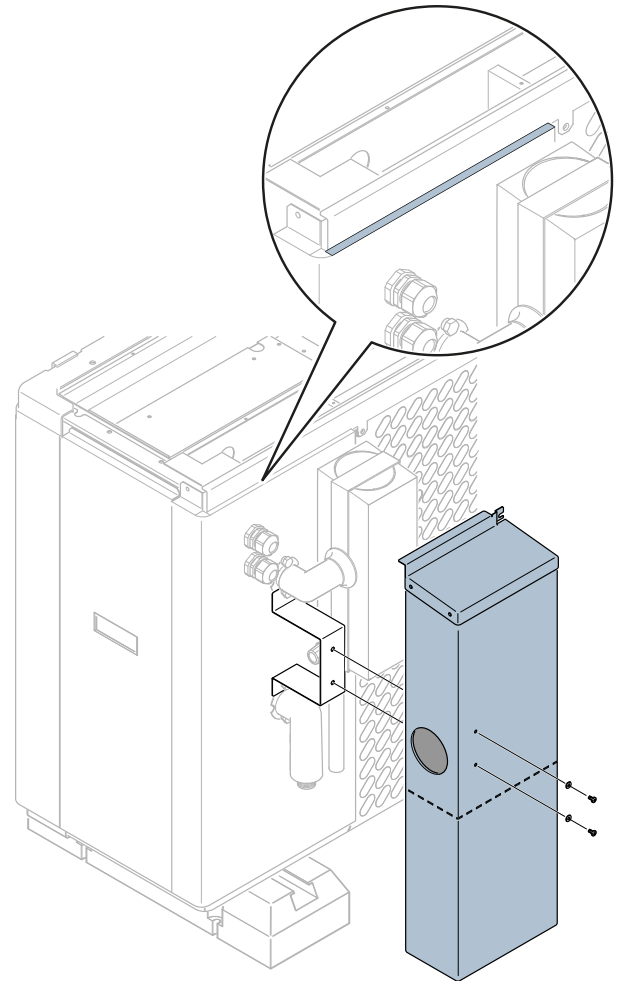

14. Reinstall the top cover on the unit.

- Place the top cover so that it is attached to the clips at the front of the unit.
- Tilt the rear of the cover downwards.

c) Fasten the screws. The left-hand screw must fasten both the top cover and the gas separator casing.

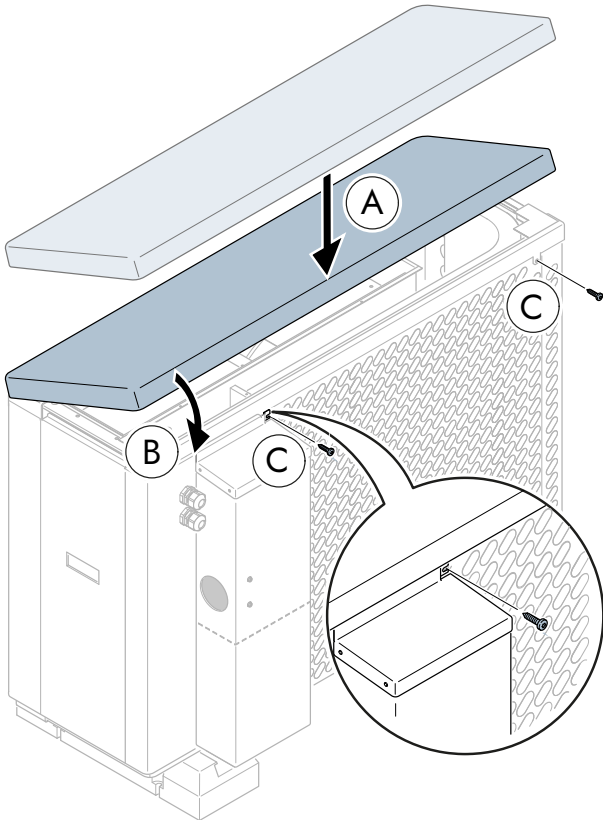

15. Attach the cover for the safety valve (FL2) to the gas separator casing.

