

# FREE STANDING HOT WATER STORAGE TANKS

## 200, 250, 300, 400, SE series



**APPLICATION:** storage of hot domestic water.



It is **POSSIBLE to heat water ADDITIONALLY** by means of an electric heater to be optionally installed.



**DURABILITY** is ensured by the implementation of a magnesium anode and ceramic enamel, fired at a temperature of 850 °C.



**INSULATION** made of polyurethane foam.



**AESTHETIC HOUSING** made of skay-type cloth. Available in 3 colour versions: gray, red, dark blue.

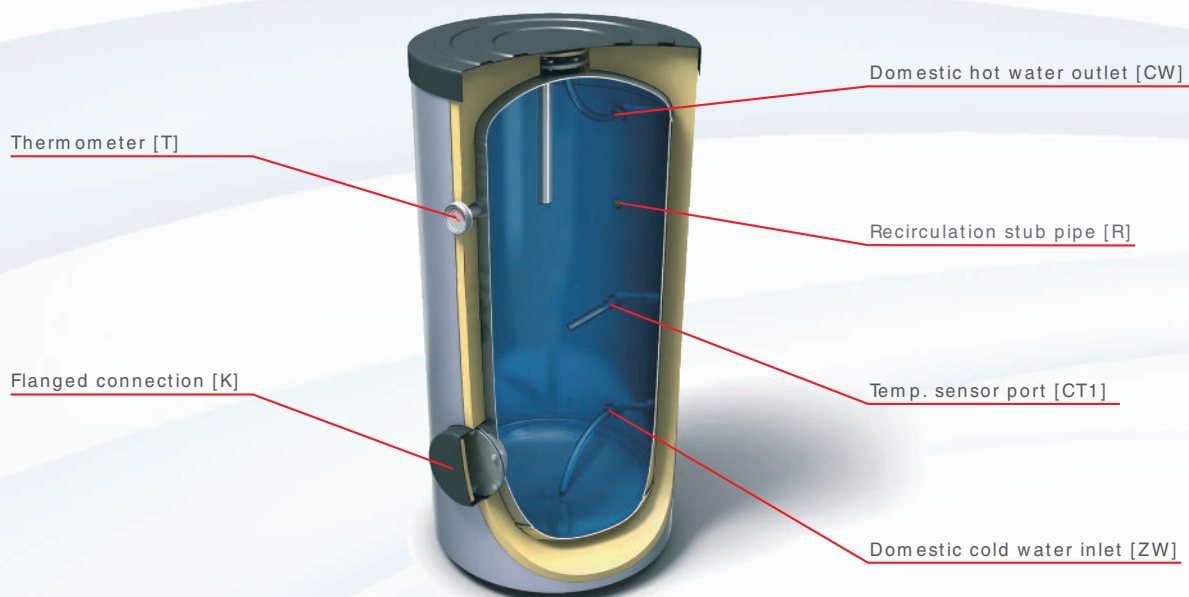

	Type	200	250	300	400
Symbol		15.200SE	15.250SE	15.300SE	15.400SE
Nominal capacity	L	200	250	300	400
Actual capacity	L	207	255	305	401
Maximum rated temperature	°C	90			
Minimum rated temperature	°C	5			
Maximum tank working pressure	Bar	6			
Thermal insulation		PUR foam			
Weight (without water)	kg	66	79	87	105

P.P.U.H. LEMET reserves the right to introduce modifications without providing prior notice or justification.

# FREE STANDING HOT WATER STORAGE TANKS 200, 250, 300, 400, SE series - TECHNICAL DIAGRAM

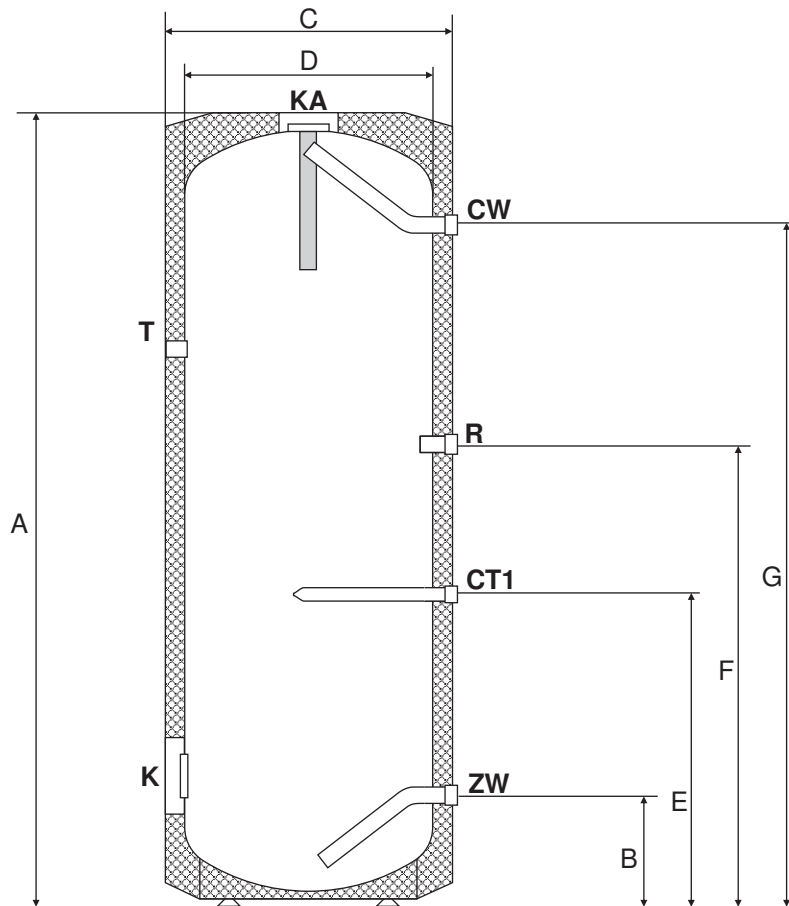

TYP	A	B	C	D	E	F	G
200	1250	180	600	500	440	780	1010
250	1470	190	600	500	480	890	1205
300	1520	210	650	550	510	930	1240
400	1820	270	650	550	510	1180	1570

SYMBOL	TYPE
CW - hot water outlet	G 3/4" Internal
R - recirculation stub pipe	G 3/4" Internal
CT1 - bushing for a temperature sensor	G 1/2" Internal
ZW - cold water inlet	G 3/4" Internal

SYMBOL	TYPE
T - thermometer	
K - flanged connection	
KA - flange with the anode	

P.P.U.H. LEMET reserves the right to introduce modifications without providing prior notice or justification.